

**Truckline Inc.**

Call Toll Free **800-684-9799**

Truck & Trailer Body Parts Mfg. & Sales

**Tel: 201-703-7933**

Web Site **WWW.TRUCKLINE-SALE.COM**

**Fax: 201-791-4588**

# Floors

**Aluminum Inverted T Floor**

**Aluminum Non Slippery Textured Floor**

**Aluminum Textured Floor**

**Aluminum Extrusion Flat Floor**

**Laminated Oak Hardwood**

**Laminated Hardwood**

**Apitong Wood Floor**

- ☺ **If you don't see what you need here, please let us know.**
- ☺ **We Carry Aluminum, Steel & Wood Floor.**
- ☺ **We have counter sunk rivets to be used for Aluminum & Steel Floors.**

**Aluminum Extrusions**

# Truckline Inc.

Call Toll Free **800-684-9799**

Truck & Trailer Body Parts Mfg. & Sales

**Tel: 201-703-7933**

Web Site **WWW.TRUCKLINE-SALE.COM**

**Fax: 201-791-4588**

Description : **FLOOR - Inverted T floor (Non Slippery)**

Material: **Aluminum 6061-T6**

Part # **TL-FLOR-001-A-xx** **9" Board**

Size: **Up to 53' long**

**-B-xx** **Center Key**

**-C-xx** **Sides**

**-D-xx** **10" Board**

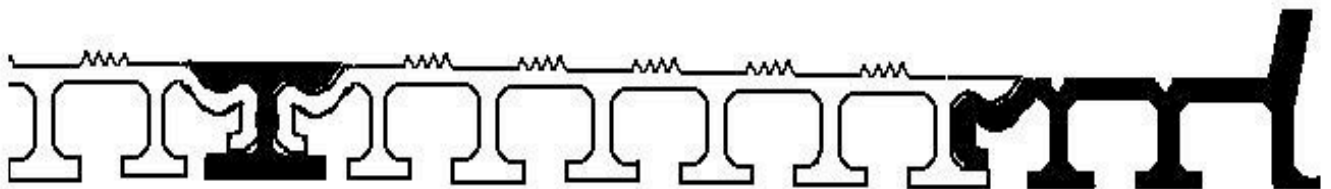
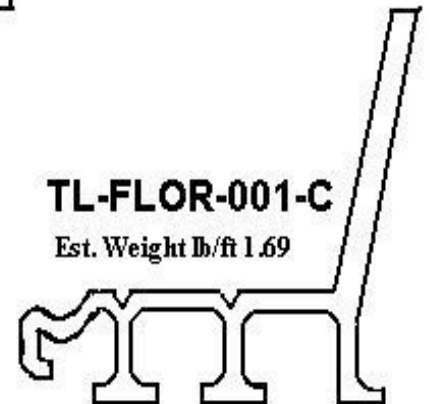
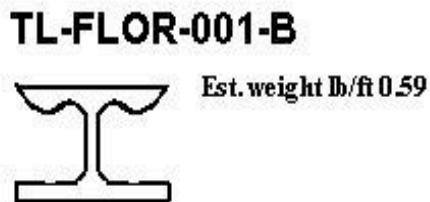
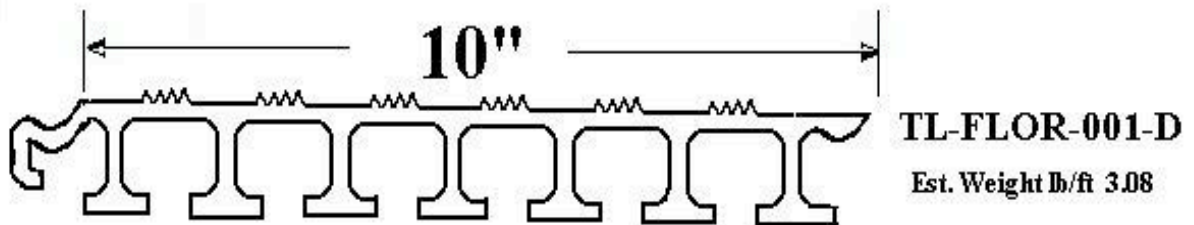
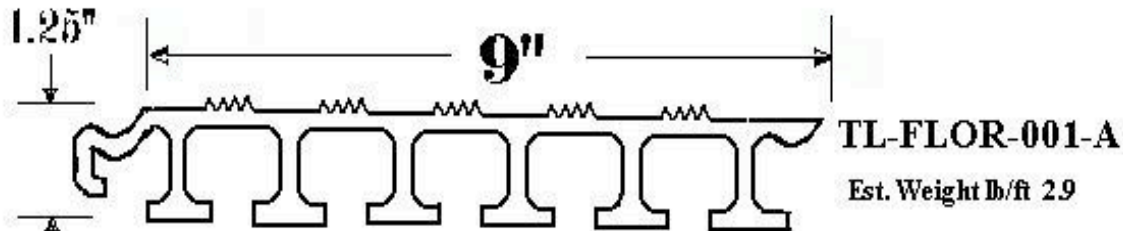

## Aluminum Extrusions

# Truckline Inc.

Call Toll Free **800-684-9799**

Truck & Trailer Body Parts Mfg. & Sales

**Tel: 201-703-7933**

Web Site **WWW.TRUCKLINE-SALE.COM**

**Fax: 201-791-4588**

Description : **FLOOR - Inverted T floor (Non slippery)**

Material: **Aluminum 6061-T6**

Part # **TL-FLOR-001-A-xx**      **9" Board**

Size: **Up to 53' long**

**-B-xx**      **Center Key**

**-C-xx**      **Sides**

**-D-xx**      **10" Board**

## Board Combination based on Body wide

Width	Number of Boards when using End Boards & Key		Number of Boards when no End Boards are used	
	9" Boards	10" Boards	9" Boards	10" Boards
88"	3	5	2	7
89"	2	6	1	8
90"	1	7	0	9
91"	0	8	9	1
92"	9	0	8	2
93"	8	1	7	3
94"	7	2	6	4
95"	6	3	5	5
96"	5	4	4	6
97"	4	5	3	7
98"	3	6	2	8
99"	2	7	1	9
100"	1	8	0	10
101"	0	0	9	2
102"	9	1	8	3

## Aluminum Extrusions

# Truckline Inc.

Call Toll Free **800-684-9799**

Truck & Trailer Body Parts Mfg. & Sales

**Tel: 201-703-7933**

Web Site **WWW.TRUCKLINE-SALE.COM**

**Fax: 201-791-4588**

Description : **FLOOR - Textured Floor (Non slippery)**

Material: **6061-T6**

Part # **TL-FLOR-007-A-xx**  
**-B-xx**

Size: **Up to 53'**

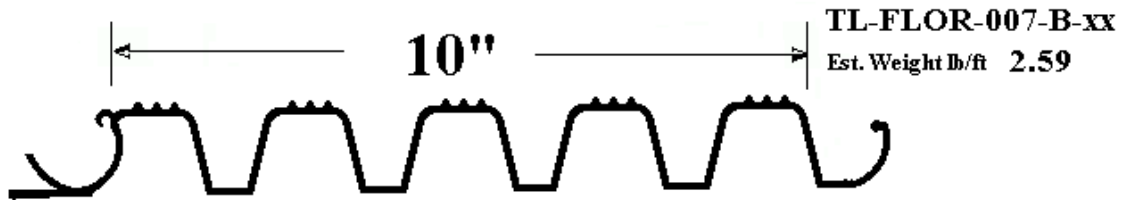
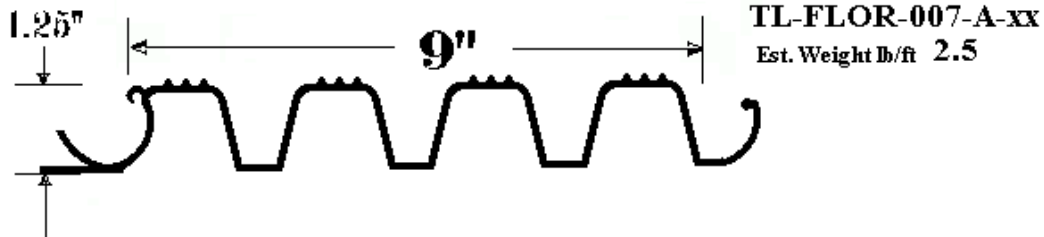

Width	Number of Boards when using End Boards & Key		Number of Boards when no End Boards are used	
	9" Boards	10" Boards	9" Boards	10" Boards
88"	3	5	2	7
89"	2	6	1	8
90"	1	7	0	9
91"	0	8	9	1
92"	9	0	8	2
93"	8	1	7	3
94"	7	2	6	4
95"	6	3	5	5
96"	5	4	4	6
97"	4	5	3	7
98"	3	6	2	8
99"	2	7	1	9
100"	1	8	0	10
101"	0	0	9	2
102"	9	1	8	3

# Truckline Inc.

Call Toll Free **800-684-9799**

Truck & Trailer Body Parts Mfg. & Sales

Tel: **201-703-7933**

Web Site **WWW.TRUCKLINE-SALE.COM**

Fax: **201-791-4588**

Description : **FLOOR - Smooth Floor**

Material: **6061-T6**

Part # **TL-FLOR-010-A-LF - 7.875" Boards**

Size: Up to 53'

**TL-FLOR-010-B-LF - 10.125" Boards**

**TL-FLOR-010-C-LF - Center Key**

**TL-FLOR-010-D-LF - Side Kike**

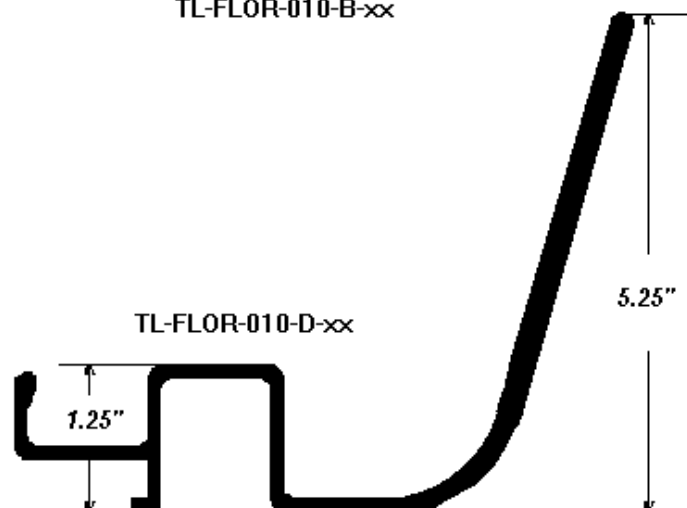
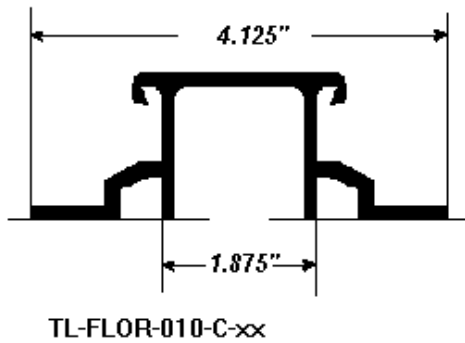
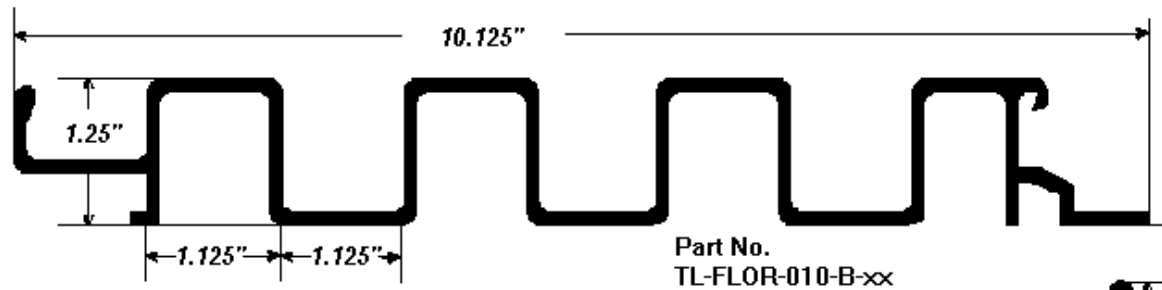
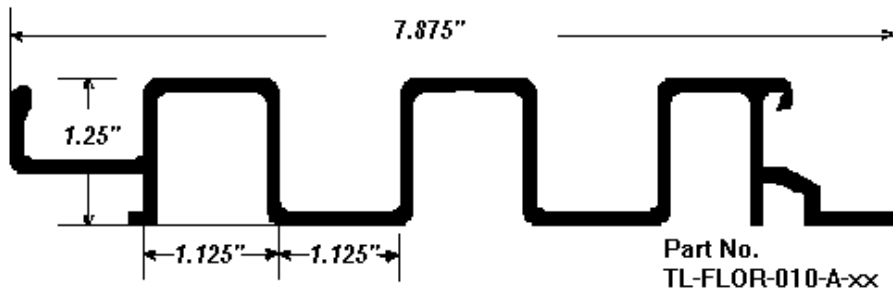

# Truckline Inc.

Call Toll Free **800-684-9799**

Truck & Trailer Body Parts Mfg. & Sales

**Tel: 201-703-7933**

Web Site **WWW.TRUCKLINE-SALE.COM**

**Fax: 201-791-4588**

Description: **Light use Floor**  
Part # **TL-AEXT-010-XX**

Material: 6061-T6  
Approx. Weight/ft - **1.0 Lbs**  
Size: **Up to 24'** in stock

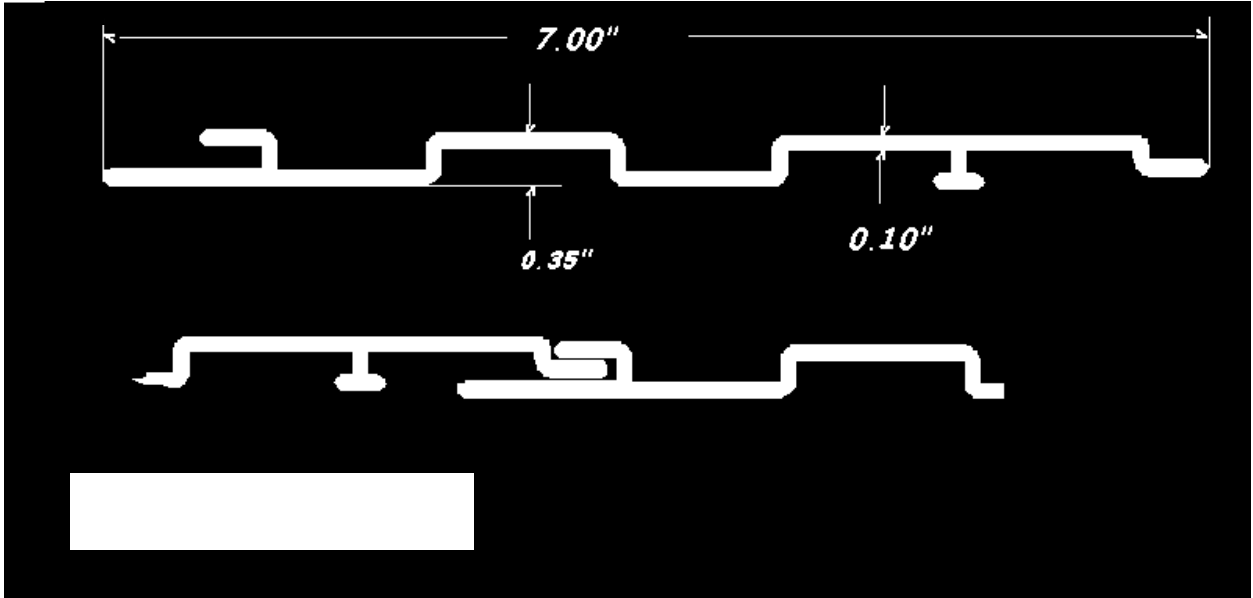

# Truckline Inc.

Call Toll Free **800-684-9799**

Truck & Trailer Body Parts Mfg. & Sales

Tel: **201-703-7933**

Web Site **WWW.TRUCKLINE-SALE.COM**

Fax: **201-791-4588**

Description :

## **Solid Flooring for Truck, Trailer, Flatbeds or Platforms With 1/2" lap**

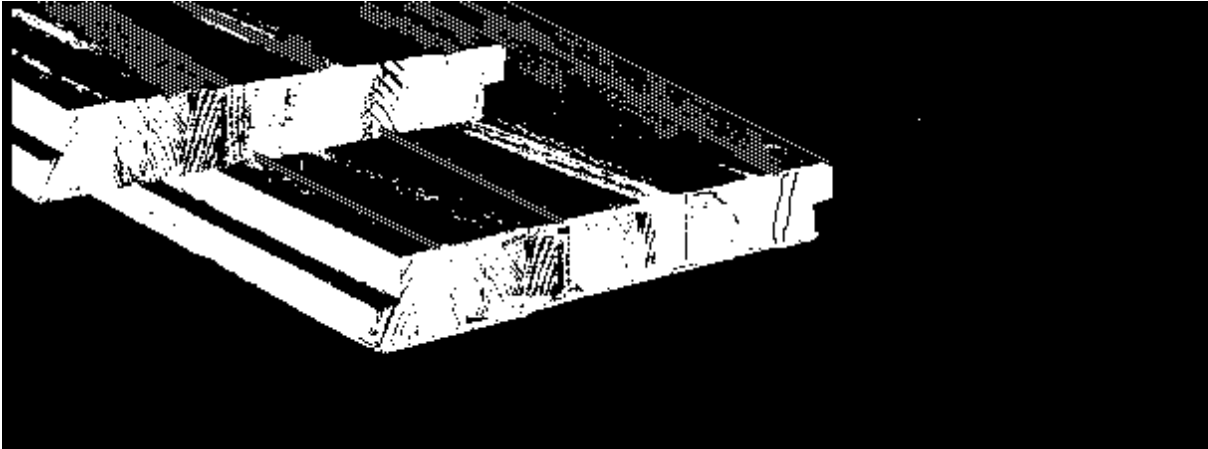

Part Number	Size*		Description
	Face	Thickness	
TL-Floor-004-A	5"	1-5/16"	Apitong/Keruing Length is varied
TL-Floor-004-B	5"	1-1/8"	Apitong/Keruing Length is varied
TL-Floor-005-A	7"	1-5/16"	Apitong/Keruing Length is varied
TL-Floor-005-B	7"	1-1/8"	Apitong/Keruing Length is varied
TL-Floor-006-B	4' x 8'	1-1/8"	Keruing/Kapur Treated Plywood (treated W/Babbillium to Australian quarantine requirements)
TL-Floor-008-A	11 3/4"	1-1/8"	Laminated Oak Length is made to size L/F
TL-Floor-008-B	11 3/4"	1-1/8"	Laminated Oak made to size S/F

# Truckline Inc.

Call Toll Free **800-684-9799**

Truck & Trailer Body Parts Mfg. & Sales

**Tel: 201-703-7933**

Web Site **WWW.TRUCKLINE-SALE.COM**

**Fax: 201-791-4588**

Description : **Aluminum Tread Plate**

Material **3003 Bright Aluminum**

Part # **TL-FLOR-002**

Comment: **Stock Item**

Size Available: **1/8"x48"x96"**

**Other Sizes Can Be Ordered**

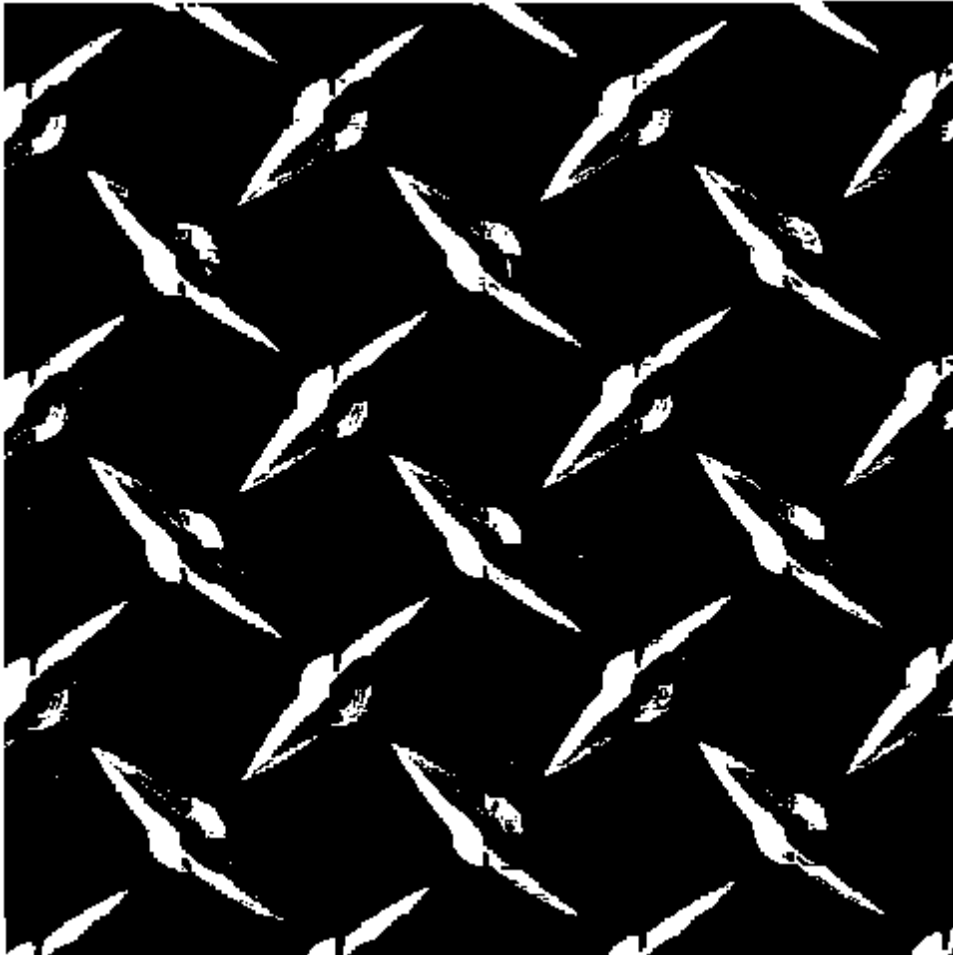

Description : **Steel Tread Plate**

Part # **TL-FLOR-003-01**

Comment: **Stock Item**

Size Available: **1/8"x48"x96"**

**Other Sizes Can Be Ordered**

# Truckline Inc.

Call Toll Free **800-684-9799**

Truck & Trailer Body Parts Mfg. & Sales

**Tel: 201-703-7933**

Web Site **WWW.TRUCKLINE-SALE.COM**

**Fax: 201-791-4588**

Description : **FLOOR - Flat Inverted T floor**

Material: **Aluminum 6061-T6**

Part # **TL-FLOR-011-A-xx**

Size: **Up to 53' long**

